

scorrevoli a libro

sliding folding systems - Glas falt Schiebewände

L-1000 / L-1500 / L-2000 / L-2500





Il sistema per pareti mobili a libro Metalglas è composto da cerniere in ottone stampato a caldo, scorrevoli e pieghevoli sulla guida superiore in alluminio anodizzato. Una speciale tecnica di costruzione permette alle cerniere di scorrere nella guida con elevatissima scorrevolezza.

The folding glass wall system by Metalglas is composed of forged brass hinges, sliding and folding on the top guide in anodized aluminium. The special technology construction of the hinge carriers allows a high level of sliding.

Das Glas-Falt Schiebewandssystem Metalglas besteht aus geschmiedeten Bänder aus Messing und aus eine obere Laufschiene aus eloxiertem Aluminium. Der Bandlaufwagen lässt sich durch eine spezielle Rollentechnik leichtlaufend bewegen.

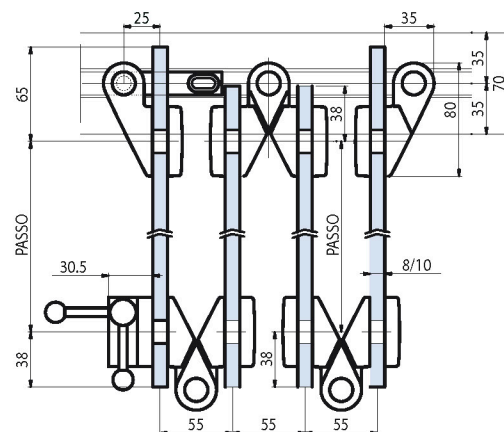
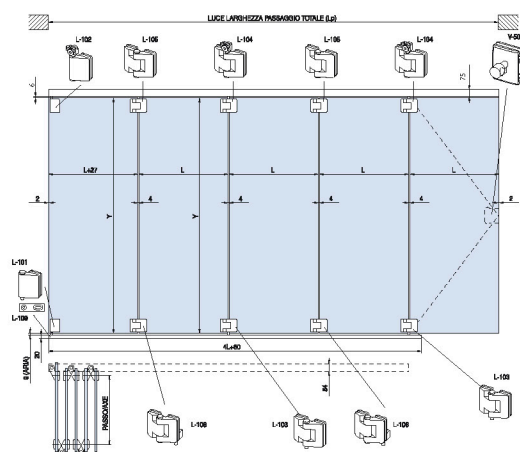

scorrevoli a libro

sliding folding systems - Glas falt Schiebewände

L-1000 / L-1500 / L-2000 / L-2500



Le dimensioni massime di ogni anta sono 1000 x 3000 con guida a pavimento, per massimo 5 ante per lato, quindi 10 ante totali. Spessore vetro 8 o 10 mm.
The maximum dimensions of every panel are 1000 x 3000 with floor guide, for maximum 5 panels for side therefore 10 panels totals. Thickness glass 8 or 10 mm.
Max Falflügelgrößen sind: max. Flügelbreite 1000, max gesamthöhe 3000 mit Bodenführung. Max Falflügel pro Seite so insgesamt 10 Falflügel möglich. Glasdicken 8 mm bzw. 10 mm.



scorrevole a libro L-1000

componenti - components - Einzelteile

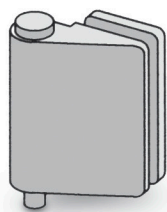

L-101

Cerniera laterale inferiore per prima/ultima anta

Bottom hinge fitting for first/last panel

Unteres seitliches Band für erstes/letztes Element

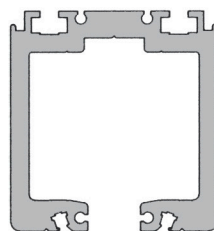

L-100

Binario superiore di scorrimento in alluminio

Alluminium top track profile

*Aluminium
Laufschienenprofil*

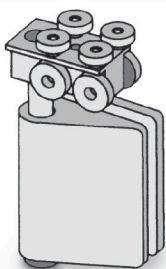

L-102

Cerniera laterale superiore per prima/ultima anta

Top hinge fitting for first/last panel

Oberes seitliches Band für erstes/letztes Element

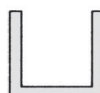

L-110

Guida a pavimento

Bottom rail

Bodenführung

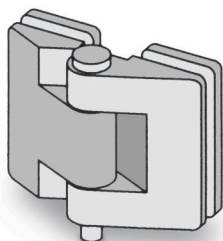

L-103

Cerniera inferiore di scorrimento per guida pavimento

Bottom sliding hinge for bottom rail

Unteres Falmband für Fußboden Führung



L-108

Fermi per prima/ultima anta

Stoppers for first/last panel

Endanschläge für erstes/letztes Element

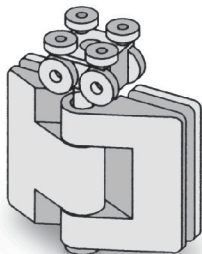

L-104

Cerniera superiore di scorrimento in guida

Top sliding hinge for the track profile

Oberes Falmband mit Laufwagen für Laufschiene



L-109

Pozzetto per cerniera inferiore prima/ultima anta

Bottom pivot adaptor for first/last panel

Bodenbuchse für erstes/letztes Element

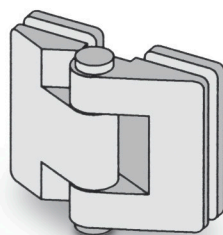

L-105

Cerniera centrale inferiore/superiore

Top/bottom hinge

Unteres/oberes Falmband

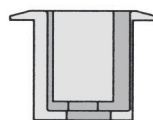

L-111

Pozzetto inferiore eccentrico regolabile per perno

Floor socket eccentric with adjustable insert

Extenterschliess Buchse verstellbar

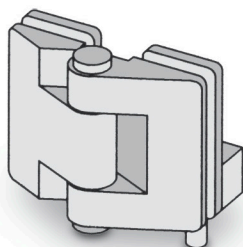

L-106

Cerniera inferiore completa di catenacciolo di chiusura (per impacchettamento interno)

Bottom hinge fitting with locking bolt (folding inside)

Unteres Falmband mit unterer Verriegelung

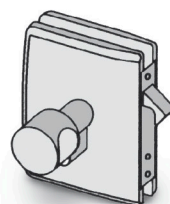

V-504

Serratura minima con scrocco a gancio per scorrevole vetro

Minima lock with hook for glass sliding door

Minima Schloßkasten mit Hakenfalle für Glasschiebetür